

2100-SVCF

SmartView 2 Panel Mount Elevator Camera



Clear, integrated video for elevator emergency communication.

- Provides clear video for elevator emergency communication.
- Panel-mount design integrates cleanly into elevator fixtures.
- Optimized for use with SmartView 2 systems.
- Durable design supports long-term performance in elevator environments.
- Compliant with ASME A17.1 and CSA B44 requirements.
- ETL listed.



Specifications

	2100-SVCF
Mounting	Panel Mount
Weight	0.5 lbs
Bracket Mounting Dimensions	2.75" x 3.9" x 1.0"
Dimensions	1.49" x 1.49" x 0.98"
Enclosure	Stainless Steel
Pour Source	RATH® SmartView 2 Elevator Unit
Wiring Requirements	USB Cable
Environmental	32 - 140°F
Warranty	2 Years
Voltage	5 VDC @ 100 mA
Included Components	Camera, Acrylic Dome, Panel Mount Bracket, USB Cable

AVIRE

N56W24720 N Corporate Cir., Sussex, WI 53089
800-451-1460

sales.us@avire-global.com
avire-global.com/en-us

Dimensions

Top View

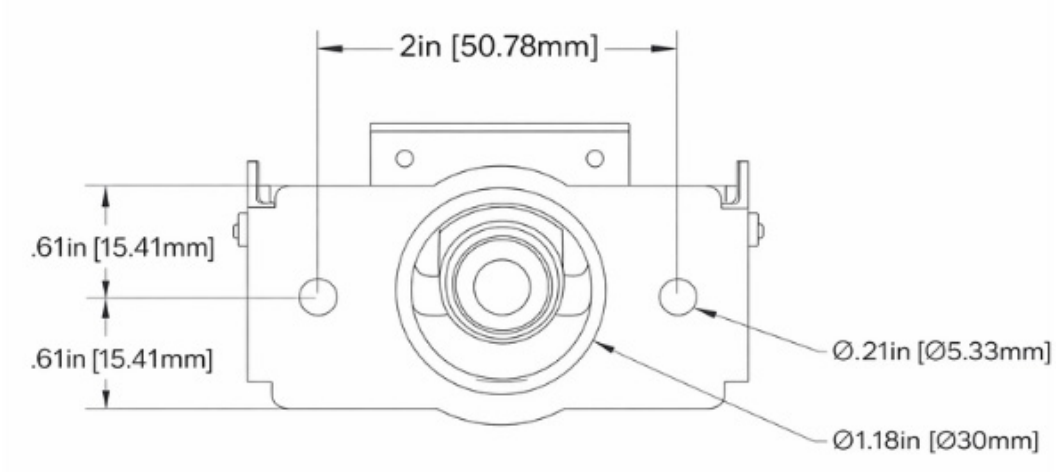

Side View

