

# Command System Call Box

2400-808NSP



Part #: 2400-808NSP

## Specifications

### Dimensions:

Face Plate: 9-1/2" H x 7-1/2" W

Back Box: 8" H x 6" W x 3" D

**Mounting:** Flush Mount

**Design:** Brushed Stainless Steel

**Warranty:** 2 Years

### Code Compliance:

- International Building Code (IBC)
- National Fire Protection Association (NFPA)
- Americans Disabilities Act (ADA)

### Power Requirements:

- Designed to be powered from the Distribution Module and requires a single pair from the Distribution Module

### Programming Features:

- Programmable with up to 2 emergency phone numbers
- On-site programming
- Recordable location message (25 seconds)
- On-site programming capability with numeric programming

### Phone Capabilities:

- Recordable location message (25 seconds)
- Automatic dialer (31 digit programmable memory)
- Automatic answer feature with audible ring

### Optional Features:

- Mushroom push button

# Command System Call Box

## 2400-808NSP

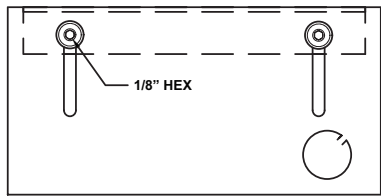

(A) INTERIOR ELEVATION

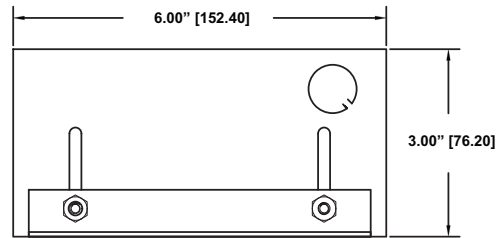

BACK BOX TOP

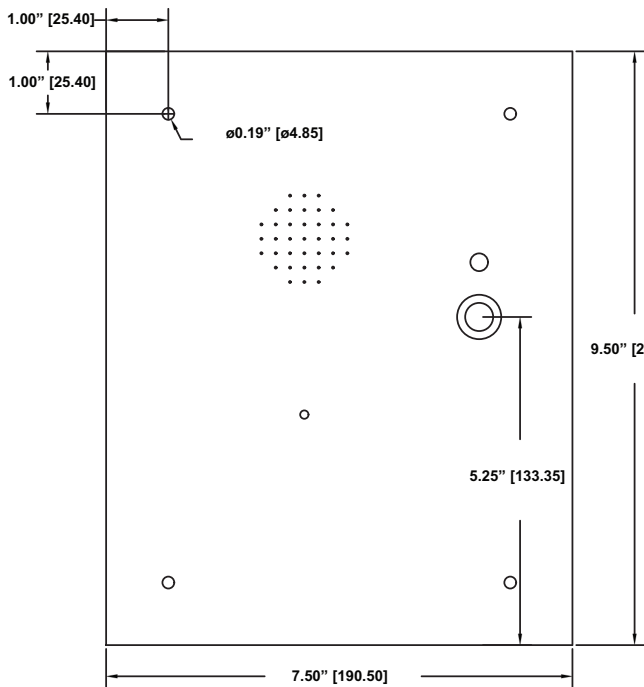

COVER FRONT

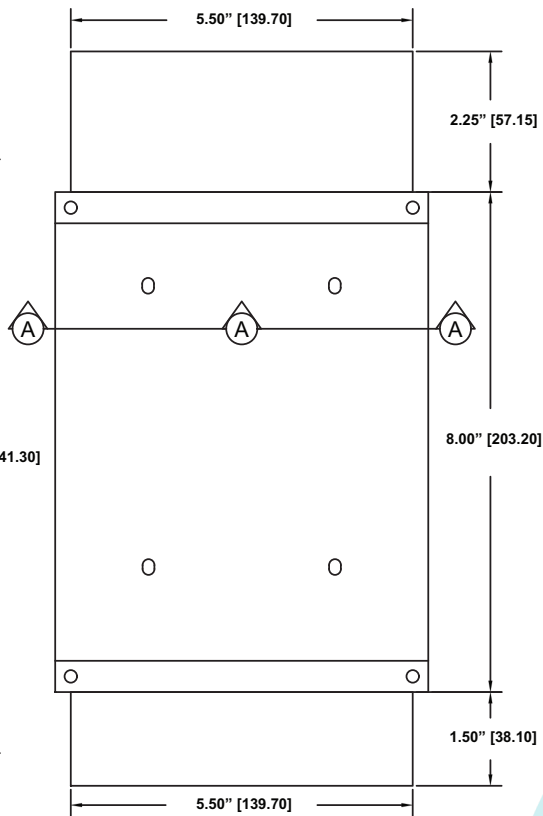

BACK BOX FRONT

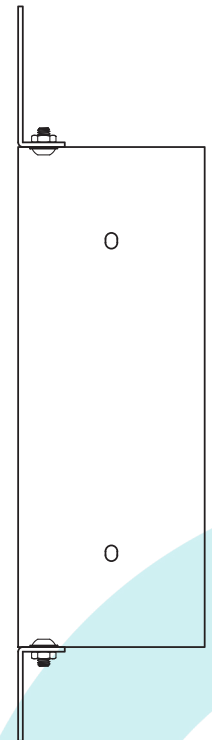

BACK BOX SIDE

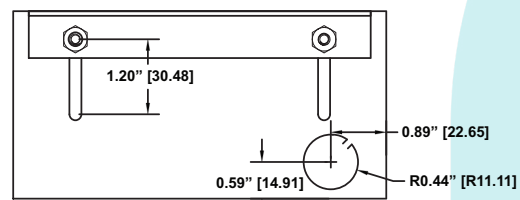

BACK BOX BOTTOM